

# Check Valve Material of Construction

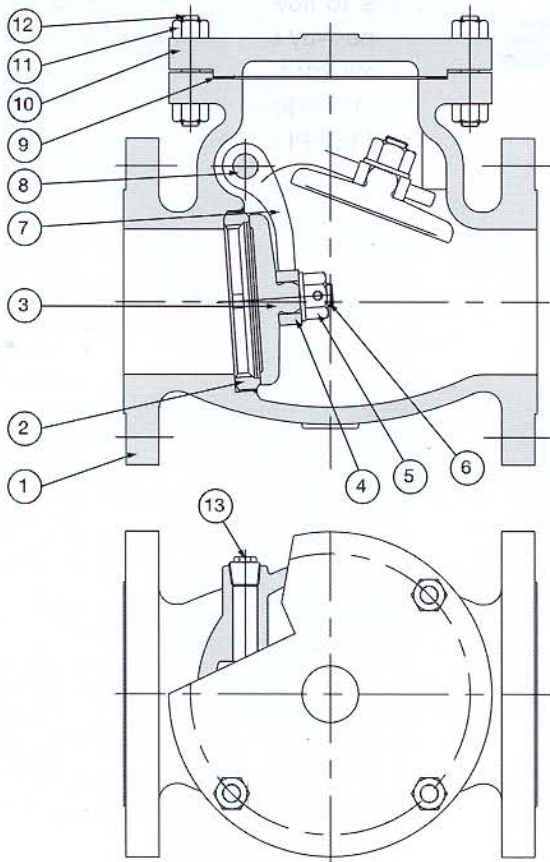

## DESIGN FEATURES:-

- 1) MFG. STD. BS 1868, API 600, ANSI B16.34
- 2) FACE TO FACE AS PER ANSI B16.10
- 3) FLANGE ENDS AS PER ANSI B16.5
- 4) TESTED AS PER BS 6755, API 598
- 5) NON SLAM ARRANGEMENT AVAILABLE UPON REQUEST
- 6) AVAILABLE WITH EXTENSION STEM

## Material of Construction

Sr No.	Part	Qty.	Material	Specification
1	Body	1	Cast Carbon Steel	ASTM-A-216 Gr. WCB
2	Seat Ring	1	Carbon Steel Faced with 13% Cr. Steel	
3	Disc	1	ASTM-A-216 Gr. WCB Faced with 13% Cr. Steel	
4	Disc Washer	1	Stainless Steel	AISI 304
5	Disk Nut	1	Stainless Steel	AISI 304
6	Splite Pin	1	Stainless Steel	AISI 304
7	Hinge	1	Cast Carbon Steel	ASTM-A-216 Gr. WCB
8	Hinge Pin	1	Stainless Steel	AISI 410
9	Gasket	1	S.S. 304 Spiral Wound with CAF	
10	Cover	1	Cast Carbon Steel	ASTM-A-216 Gr. WCB
11	Cover Stud Nut	REQ	Carbon Steel	ASTM-A-194 Gr. 2H
12	Cover Stud	AS	Alloy Steel	ASTM-A-193 Gr. B7
13	Hung Pin Plug	1	Forged Carbon Steel	ASTM-A-105

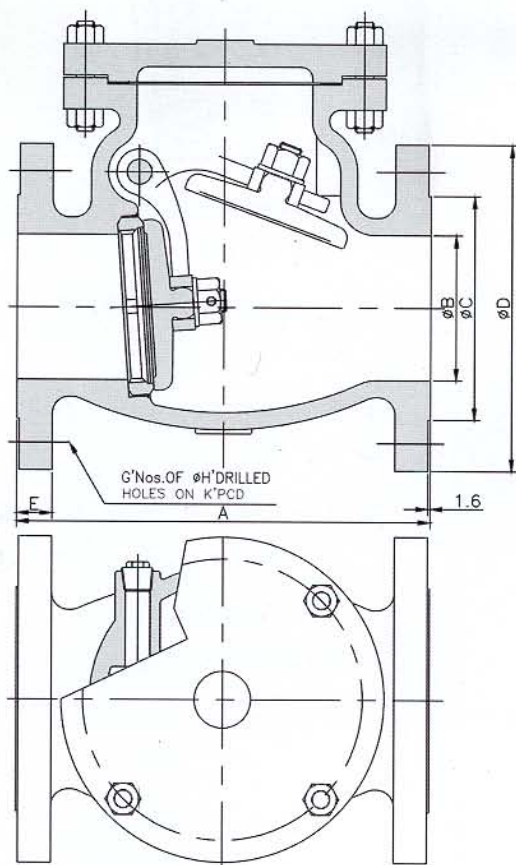

## DESIGN FEATURES:-

- 1) MFG. STD. BS 1868, API 600, ANSI B16.34
- 2) FACE TO FACE AS PER ANSI B16.10
- 3) FLANGE ENDS AS PER ANSI B16.5
- 4) TESTED AS PER BS 6755, API 598
- 5) NON SLAM ARRANGEMENT AVAILABLE UPON REQUEST
- 6) AVAILABLE WITH EXTENSION STEM

## Class-150

Size (NB)	A	B	C	D	E	G	H	K
2" (50)	203	51	91.9	152.4	15.8	4	19.1	120.7
2-1/2" (65)	216	63	104.6	177.8	19.1	4	19.1	139.7
3" (80)	241	76	127.0	190.5	19.1	4	19.1	152.4
4" (100)	292	102	157.2	228.6	23.9	8	19.1	190.5
5" (125)	330	127	185.7	254.0	23.9	8	22.2	215.9
6" (150)	356	152	215.9	279.4	25.4	8	22.2	241.3
8" (200)	495	203	269.7	342.9	28.6	8	22.2	298.5
10" (250)	622	254	323.9	406.4	30.3	12	25.4	362.0
12" (300)	699	305	381.0	482.6	31.8	12	25.4	431.8
14" (350)	787	337	412.8	533.4	35.1	12	28.6	476.3
16" (400)	864	387	469.9	596.9	36.6	16	28.6	539.8
18" (450)	977	438	533.4	635.0	39.6	16	31.8	577.9
20" (500)	977	489	584.2	698.5	42.9	20	31.8	635.0
24" (600)	1295	590	692.2	812.8	47.8	20	35.1	749.3

All dimensions are in millimeters unless otherwise specified. Dimensions are for reference only, subject to change.

# Check Valve Class 300

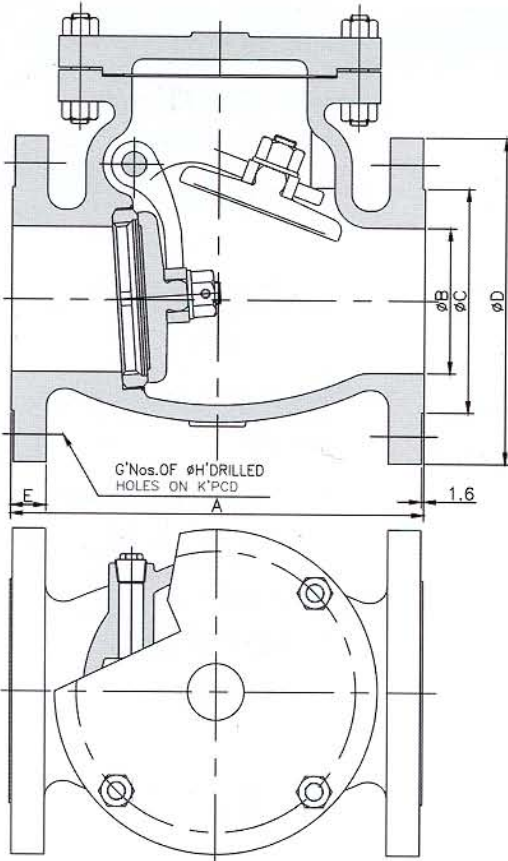

## DESIGN FEATURES:-

- 1) MFG. STD. BS 1868, API 600, ANSI B16.34
- 2) FACE TO FACE AS PER ANSI B16.10
- 3) FLANGE ENDS AS PER ANSI B16.5
- 4) TESTED AS PER BS 6755, API 598
- 5) NON SLAM ARRANGEMENT AVAILABLE UPON REQUEST
- 6) AVAILABLE WITH EXTENSION STEM

## Class-300

Size (NB)	A	B	C	D	E	G	H	K
2" (50)	267	51	91.9	165.1	22.2	8	19.1	127.0
2-1/2" (65)	292	63	104.6	190.5	25.4	8	22.2	149.4
3" (80)	318	76	127.0	209.6	28.5	8	22.2	168.1
4" (100)	355	102	157.2	254.0	31.8	8	22.2	200.2
5" (125)	400	127	185.7	279.4	35.1	8	22.2	235.0
6" (150)	444	152	215.9	317.5	36.6	12	22.2	269.7
8" (200)	558	203	269.7	381.0	41.2	12	24.5	330.2
10" (250)	622	254	323.9	444.5	47.8	16	28.6	387.4
12" (300)	711	305	381.0	520.7	50.8	16	31.8	450.9
14" (350)	838	337	412.8	584.2	53.9	20	31.8	514.4
16" (400)	864	387	469.9	647.7	57.2	20	35.1	571.5
18" (450)	977	431	533.4	711.2	60.5	24	35.1	628.7
20" (500)	1016	482	584.2	774.7	63.5	24	35.1	685.8
24" (600)	1346	584	692.2	914.4	69.9	24	41.1	812.8

All dimensions are in millimeters unless otherwise specified. Dimensions are for reference only, subject to change.

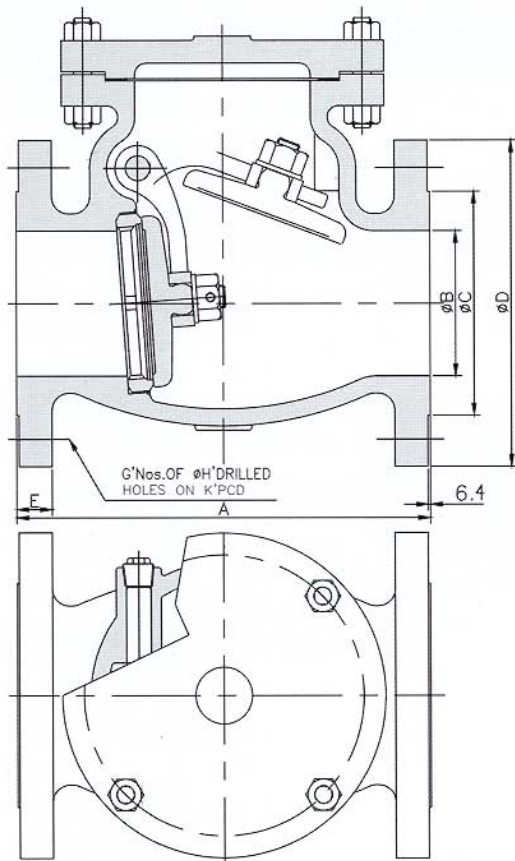

## DESIGN FEATURES:-

- 1) MFG. STD. BS 1868, API 600, ANSI B16.34
- 2) FACE TO FACE AS PER ANSI B16.10
- 3) FLANGE ENDS AS PER ANSI B16.5
- 4) TESTED AS PER BS 6755, API 598
- 5) NON SLAM ARRANGEMENT AVAILABLE UPON REQUEST
- 6) AVAILABLE WITH EXTENSION STEM

## Class-600

Size (NB)	A	B	C	D	E	G	H	K
2" (50)	292	51	91.9	165.1	31.8	8	19.1	127.0
2-1/2" (65)	330	63	104.6	190.5	34.9	8	22.2	149.4
3" (80)	356	76	127.0	209.6	38.1	8	22.2	168.1
4" (100)	432	102	157.2	273.1	44.5	8	25.4	215.9
5" (125)	508	127	185.7	330.2	50.8	8	28.6	266.7
6" (150)	559	152	215.9	355.6	54.2	12	28.6	292.1
8" (200)	660	200	269.7	419.1	62.0	12	31.8	349.3
10" (250)	787	248	323.9	508.0	69.9	16	35.1	431.8
12" (300)	838	298	381.0	558.8	73.0	20	35.1	489.0

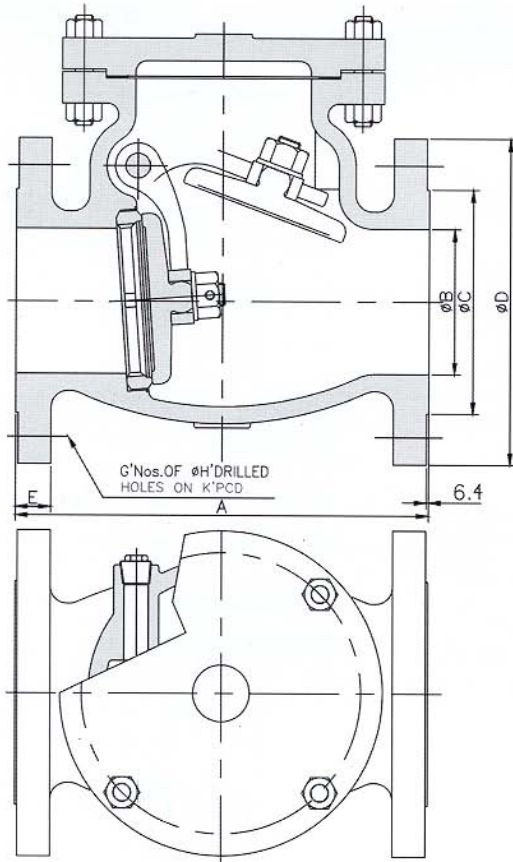

## DESIGN FEATURES:-

- 1) MFG. STD. BS 1868, API 600, ANSI B16.34
- 2) FACE TO FACE AS PER ANSI B16.10
- 3) FLANGE ENDS AS PER ANSI B16.5
- 4) TESTED AS PER BS 6755, API 598
- 5) NON SLAM ARRANGEMENT AVAILABLE UPON REQUEST
- 6) AVAILABLE WITH EXTENSION STEM

## Class-900

Size (NB)	A	B	C	D	E	G	H	K
2" (50)	368	48	91.9	215.9	44.5	8	25.4	165.1
2-1/2" (65)	419	60	104.6	244.3	47.6	8	28.6	190.5
3" (80)	381	73	127.0	241.3	44.5	8	25.4	190.5
4" (100)	457	98	157.2	292.1	50.8	8	31.8	235.0
5" (125)	559	124	185.7	349.3	57.1	8	35.0	279.4
6" (150)	610	146	215.9	381.0	62.0	12	31.8	317.5
8" (200)	737	190	269.7	469.9	69.9	12	38.1	393.7
10" (250)	838	238	323.9	546.1	76.2	16	38.1	469.9
12" (300)	965	283	381.0	609.6	85.9	20	38.1	533.4

# Check Valve Class 1500

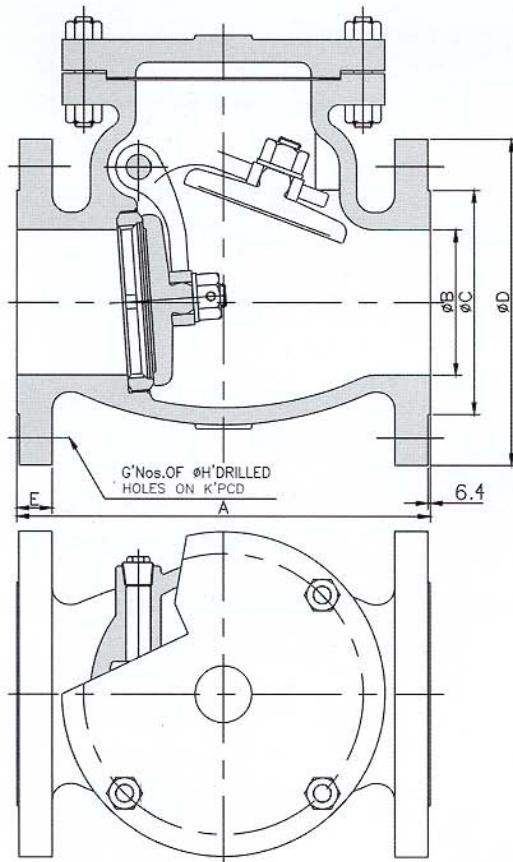

## DESIGN FEATURES:-

- 1) MFG. STD. BS 1868, API 600, ANSI B16.34
- 2) FACE TO FACE AS PER ANSI B16.10
- 3) FLANGE ENDS AS PER ANSI B16.5
- 4) TESTED AS PER BS 6755, API 598
- 5) NON SLAM ARRANGEMENT AVAILABLE UPON REQUEST
- 6) AVAILABLE WITH EXTENSION STEM

## Class-1500

Size (NB)	A	B	C	D	E	G	H	K
2" (50)	368	48	91.9	215.9	44.5	8	25.4	165.1
2-1/2" (65)	419	57	104.6	244.3	47.6	8	28.6	190.5
3" (80)	470	70	127.0	266.7	53.9	8	31.8	203.2
4" (100)	546	92	157.2	311.2	60.3	8	34.9	241.3
5" (125)	673	120	185.7	374.7	79.3	8	41.3	292.1
6" (150)	705	137	215.9	393.7	89.0	12	38.1	317.5
8" (200)	832	178	269.7	482.6	98.3	12	44.5	393.7
10" (250)	991	222	323.9	584.2	114.5	12	50.8	482.6
12" (300)	1130	264	381.0	673.1	130.3	16	54.0	571.5

All dimensions are in millimeters unless otherwise specified. Dimensions are for reference only, subject to change.

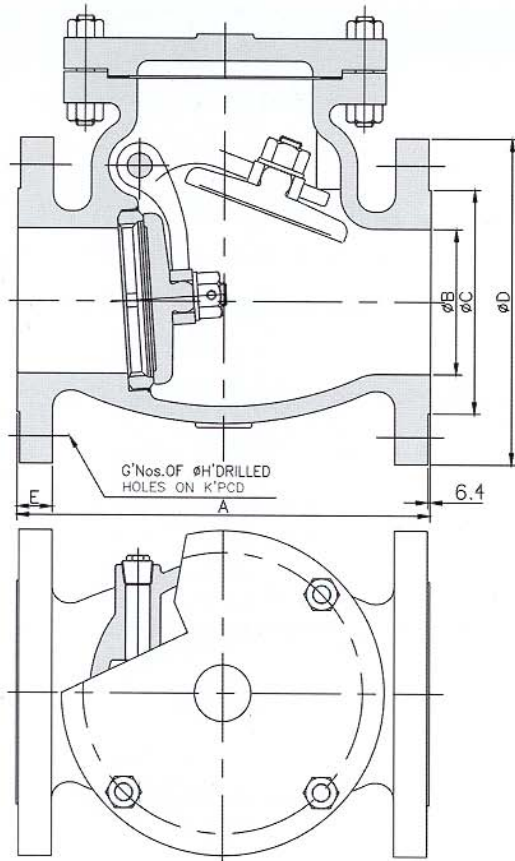

## DESIGN FEATURES:-

- 1) MFG. STD. BS 1868, API 600, ANSI B16.34
- 2) FACE TO FACE AS PER ANSI B16.10
- 3) FLANGE ENDS AS PER ANSI B16.5
- 4) TESTED AS PER BS 6755, API 598
- 5) NON SLAM ARRANGEMENT AVAILABLE UPON REQUEST
- 6) AVAILABLE WITH EXTENSION STEM

## Class-2500

Size (NB)	A	B	C	D	E	G	H	K
2" (50)	451	38	91.9	235.0	57.2	8	28.6	171.5
2-1/2" (65)	508	48	104.6	266.7	63.5	8	31.8	196.9
3" (80)	578	57	127.0	304.8	73.0	8	34.9	228.6
4" (100)	673	73	157.2	355.6	82.6	8	41.3	273.0
5" (125)	794	92	185.7	419.1	98.4	8	47.6	323.9
6" (150)	914	111	215.9	482.6	114.3	8	54.0	368.3
8" (200)	1022	146	269.7	552.5	133.4	12	54.0	438.1
10" (250)	1270	184	323.9	673.1	171.5	12	66.7	539.8
12" (300)	1422	219	381.0	762.0	190.5	16	73.0	619.4

All dimensions are in millimeters unless otherwise specified. Dimensions are for reference only, subject to change.